

# MS 400 Detector Bases

www.boschsecurity.com



**BOSCH**  
Invented for life



The detector head is installed in the Detector Base MS 400.

The base is suitable for surface-mounted cable feeds as well as for flush-mounted cable feeds, and has separate attachment points for ceiling mount/flush-mounted back boxes. In addition, it fits all standard bore patterns.

The Detector Base made of white ABS plastic (Novodur, color similar to RAL 9010) has a matt finish and seven terminal screws to connect the detector and its features to the fire panel.

Contacts connected to the terminals guarantee a secure electric connection when the detector module is installed. Cables up to 2.5 mm<sup>2</sup> in diameter can be used.

To protect against unauthorized removal, the detector head can be secured with a variable locking.

## Installation/Configuration Notes

### Installation information for 400/420 Series Detector Bases

- The drill holes marked with an "X" may only be used to mount the base to flush-mounted back boxes.
- Keep shielded auxiliary wire as short as possible, and make sure this is insulated.

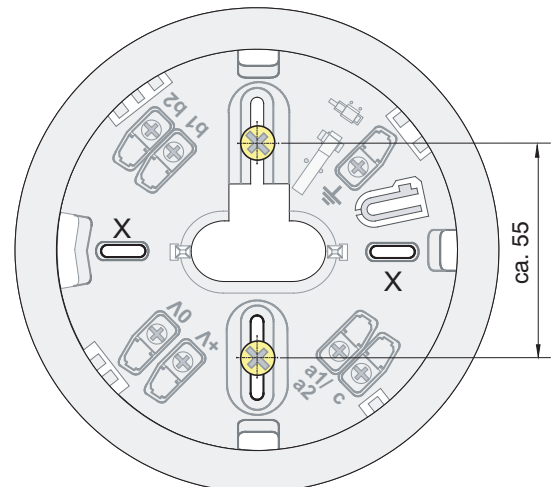
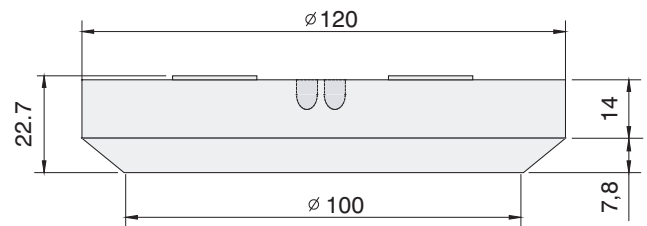

### Technical Specifications

Connections	Power supply (0 V, +V) LSN (a1/a2, b1, b2) C-point Shielding
Housing material	ABS (Novodur)
Housing color	Similar to RAL 9010
Dimensions	Ø 120 x 22.7 mm
Weight	72 g

### Ordering Information

Order number **MS 400 B**

#### **MS 400 Detector Base**

Non-branded detector base for surface-mounted and flush-mounted cable feed

Order number **MS 400**

#### **Accessories**

##### **FAA-420-SEAL Damp Room Seal**

1 package = 10 pieces

Order number **FAA-420-SEAL**

**Represented by:**

© Bosch Security Systems 2012 | Data subject to change without notice  
1259851147 | en, V1, 29. Mar 2012